

ARRANGEMENTS

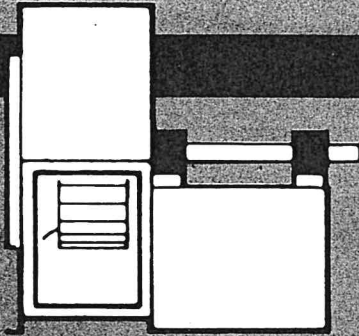

Arrangement 1

Bearings mounted on pedestal welded to fan housing with impeller overhung opposite drive end. Available for belt drive in SWSI - Single Width, Single Inlet only. Max. temp. 700° F.

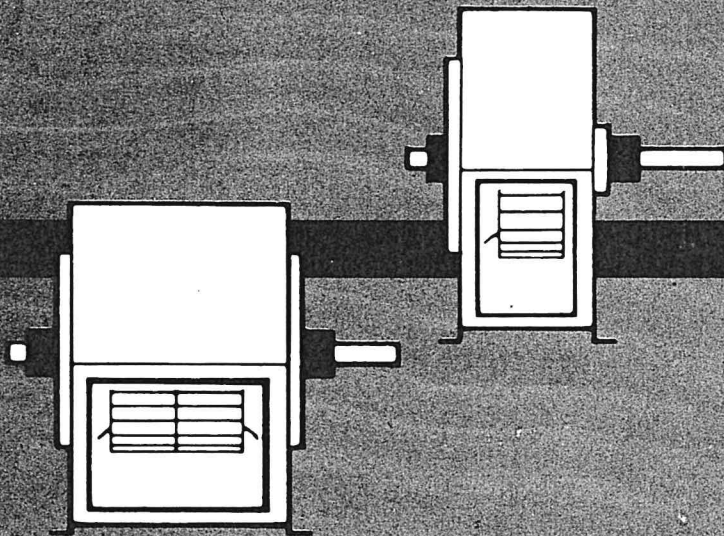

Arrangement 3

Bearings mounted on each side of fan housing with impeller center-hung. Available in SWSI - Single Width, Single Inlet (one bearing in airstream) or DWDI - Double Width, Double Inlet (both bearings in airstream). For belt or direct drive, Max. temp. 150° F.

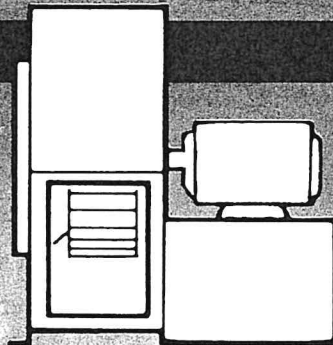

Arrangement 4

Direct drive with impeller mounted directly on motor shaft. Available in SWSI - Single Width, Single Inlet construction only. Max. temp. 200° F.

Arrangement 7

Same as Arrangement 3, but with base for motor. Available in SWSI - Single Width, Single Inlet, or DWDI - Double Width, Double Inlet construction. Direct drive. Max. temp. 150°F.

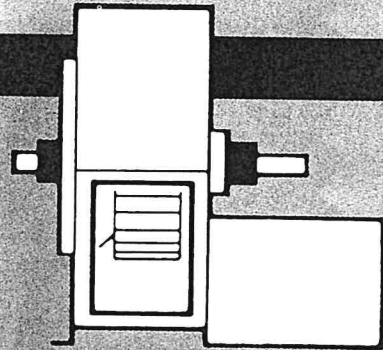

Arrangement 8

Same as Arrangement 1, but with extended pedestal for motor mounting. Available in SWSI - Single Width, Single Inlet construction only. Direct drive. Max. temp. 700°F.

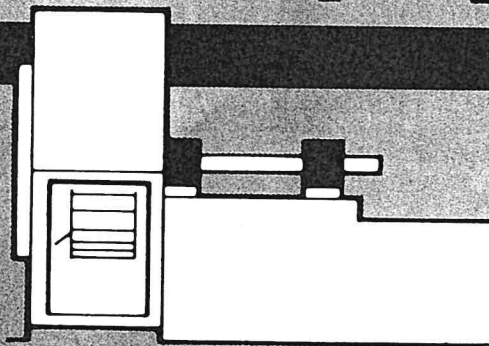

Arrangement 9

Same as Arrangement 1, with motor mounted on side of bearing pedestal. Available in SWSI - Single Width, Single Inlet construction only. Belt drive. Max. temp. 350°F (a motor shield can increase the limit to 500°F).

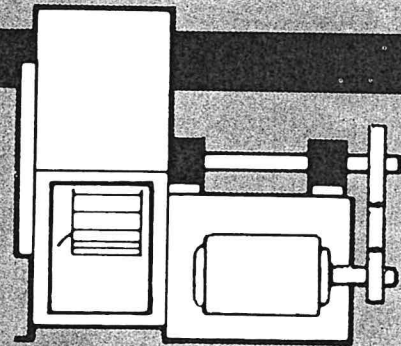

Arrangement 10

Same as Arrangement 1, but with motor mounted underneath bearing pedestal providing a complete packaged assembly. Available in SWSI - Single Width, Single Inlet construction only. Belt drive. Max. temp. 200°F.

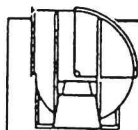
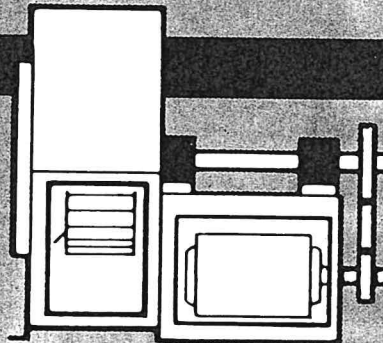

DFC

DYNAMIC FAN CORPORATION
690 S. Airport Road, P.O. Box 62
Phillips, WI 54555 -- (715) 339-2844